

NOTICE

1. * Measures are reduced to below because the draft tolerance after GTA13/5 DIN16901-130;
2. Unmarked Draft 2°.

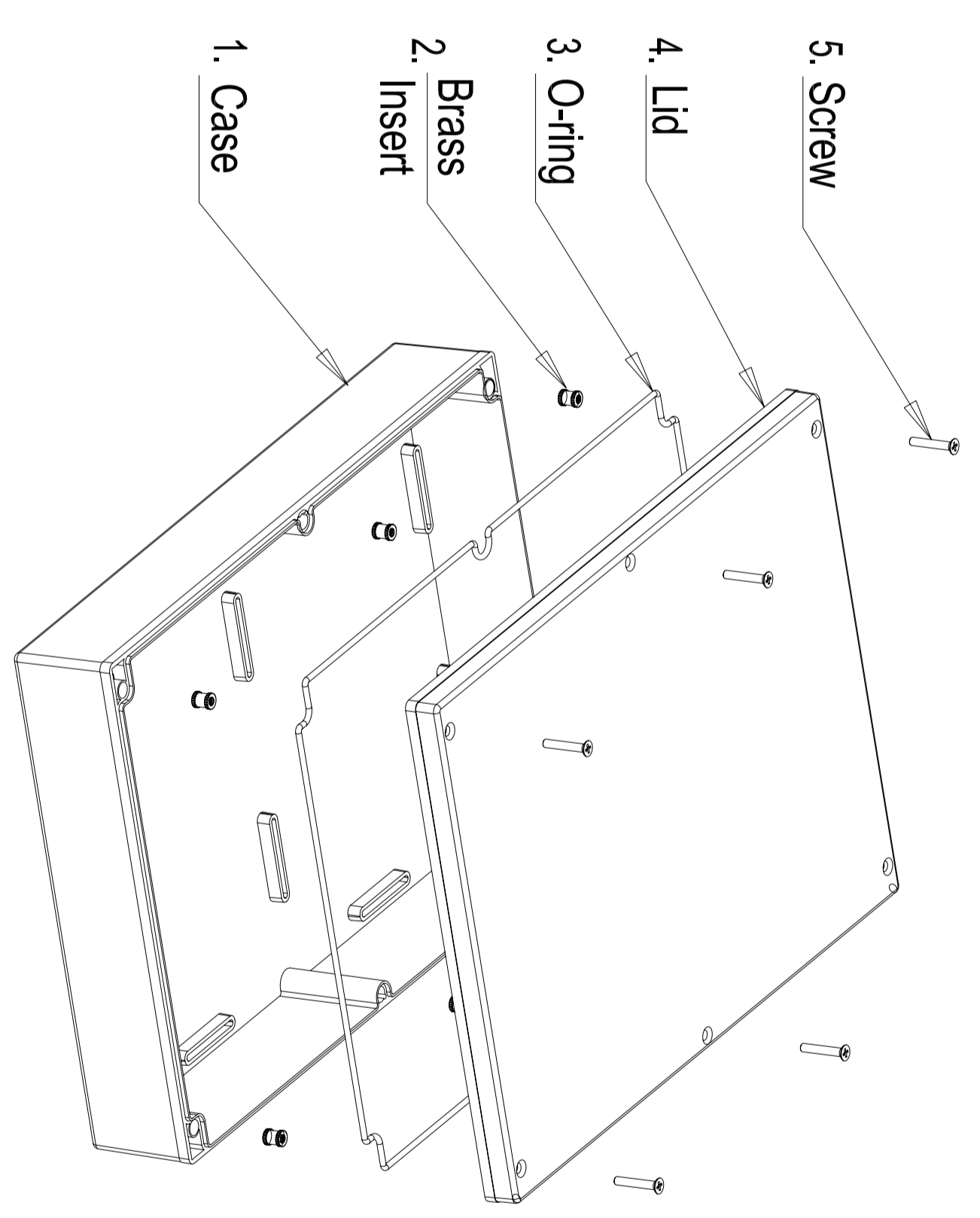

No.	Name	Qty.	Size	Material
5	Screw	6	M4X20 (DIN 965)	Stainless Steel
4	Lid	1	318X238X16	ABS
3	O-ring	1	Ø3X1130	PU
2	Insert	6	M4X8	Brass
1	Case	1	318X238X53.5	ABS

Index (Customer)	REV	Name	Date	Index (FUXIN)	REV	Name	Date

Scale: Free
Volume: mm³
Weight: 1.022 Kg



Metal Processing Co., Ltd

Part Name :

FUP 318 X 238 X 065

Drawing Number :

FUP 318 X 238 X 065

Tolerances: DIN16901 - 130
Treatment:

Designer Liu Junbin 2009.12.07

Technician Quality department
Sheet 1 of 1