

**NOTICE**

1. \* Measures are reduced to below because the draft tolerance after GTA13/5 DIN16901-130;
2. Unmarked Draft 2°.

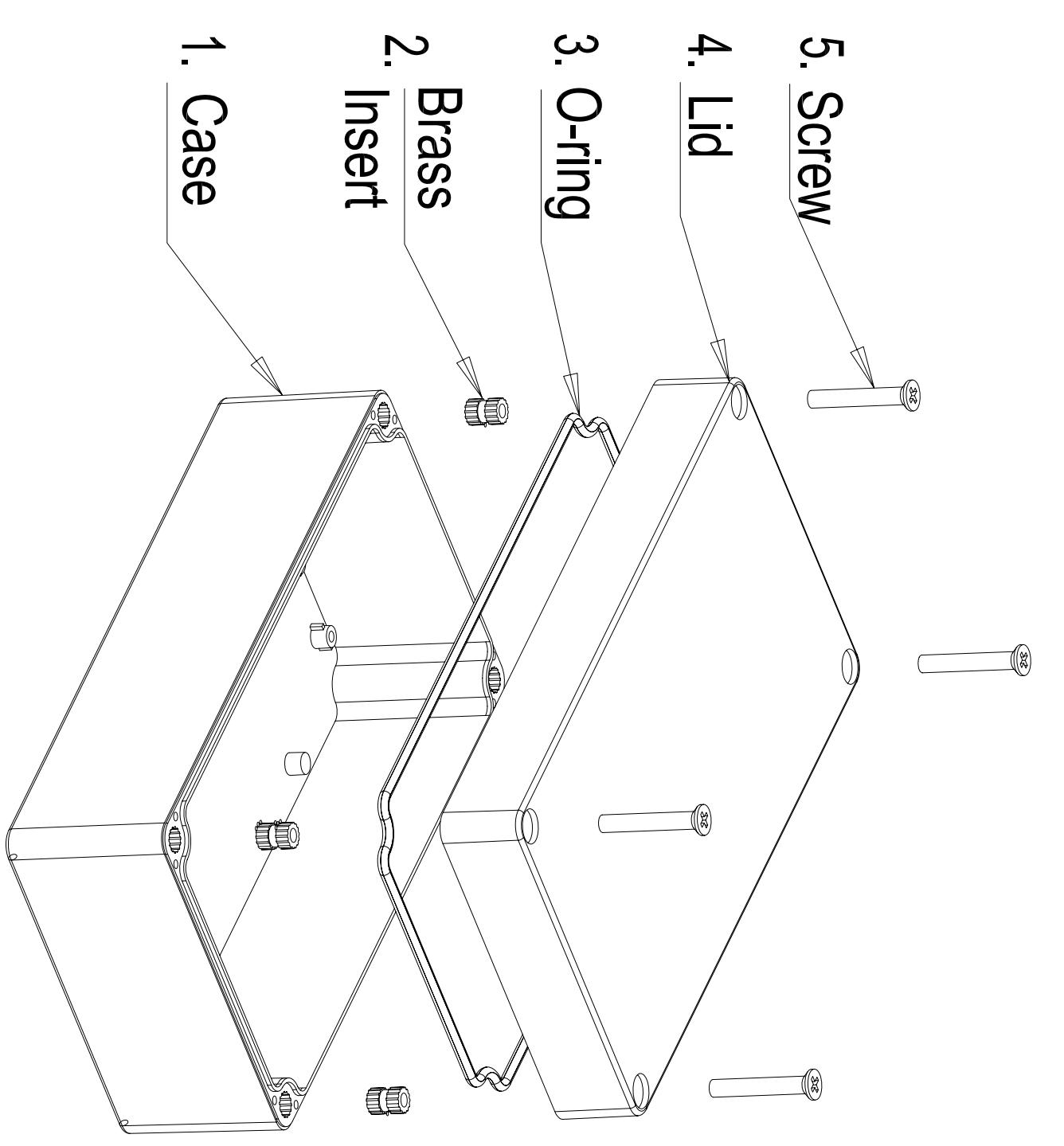

No.	Name	Qty.	Size	Material
5	Screw	4	M4X20 (DIN 965)	Stainless Steel
4	Lid	1	158X90X20	ABS
3	O-ring	1	Ø3X480	PU
2	Insert	4	M4X8	Brass
1	Case	1	158X90X41.5	ABS

Scale: Free  
 Original Material: ABS  
 Chinese Material: ABS  
 Volume: mm<sup>3</sup>  
 Weight: 0.193 Kg  
 Tolerances: DIN16901 - 130

Index (Customer)	REV	Name	Date	Index (FUXIN)	REV	Name	Date



Metal Processing Co., Ltd

Part Name :

FUP 160 X 090 X 060

Drawing Number :

FUP 160 X 090 X 060

Designer	Liu Junbin	2009.12.09
Technician		
Quality department		