

**NOTICE**  
 1. \* Measures are reduced to below because the draft tolerance after GTA13/5 DIN16901-130;  
 2. Unmarked Draft 2°.

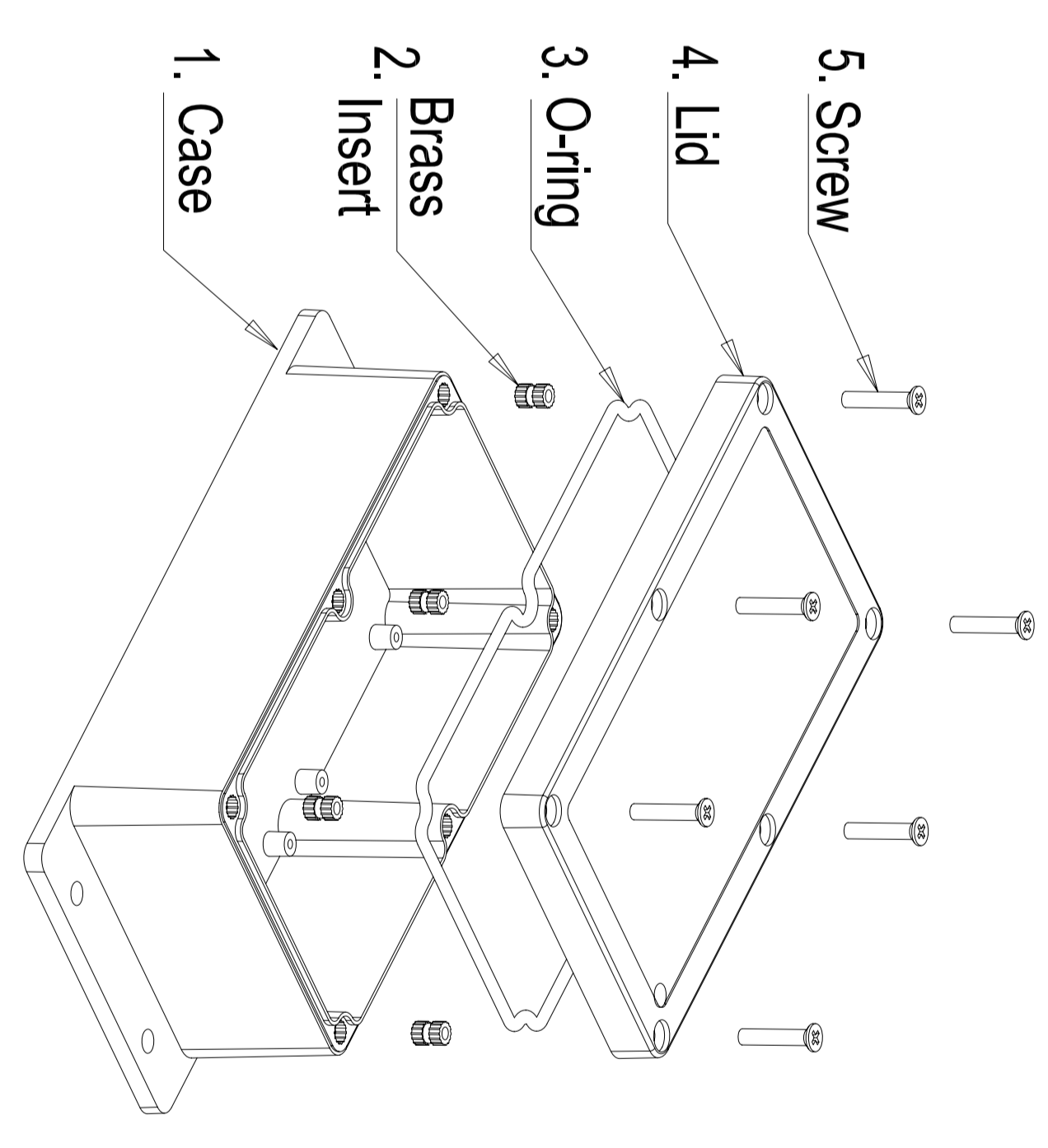

No.	Name	Qty.	Size	Material
5	Screw	6	M4X20 (DIN 965)	Stainless Steel
4	Lid	1	158X90X12	ABS
3	O-ring	1	Ø3X240	PU
2	Insert	6	M4X8	Brass
1	Case	1	158X90X49	ABS

Scale: Free  
 Original Material: ABS  
 Chinese Material: ABS  
 Volume: mm<sup>3</sup>  
 Weight: 0.222 Kg  
 Tolerances: DIN16901 - 130  
 Treatment:

Index (Customer)  
 REV  
 Name  
 Date

Index (FUXIN)  
 REV  
 Name  
 Date



Part Name :

FUP 158 X 090 X 060

Drawing Number :

FUP 158 X 090 X 060

Designer Liu Junbin 2009.12.11

Technician Quality department  
 Sheet 1 of 1